

COMMITTEE	<b>Enterprise, Strategic Planning and Infrastructure</b>
DATE	<b>13 March 2014</b>
DIRECTOR	<b>Gordon McIntosh</b>
TITLE OF REPORT	<b>Various small scale traffic management and development associated proposals (New Works)</b>
REPORT NUMBER:	<b>EPI/14/023</b>

---

### **1. PURPOSE OF REPORT**

This report is to advise Committee of the need for various small scale traffic management measures identified by officers, residents, local members, emergency services, etc and verified as necessary through surveys by officers. It also brings forward proposals associated with new developments as part of the development management process. In addition to these measures, this report also includes proposals for individual parking spaces for Blue Badge holders which now require to be progressed through the normal legal process for the required Traffic Regulation Order.

### **2. RECOMMENDATION(S)**

That the Committee:

1. Approve the proposals in principle
2. Instruct the appropriate officers to commence the necessary legal procedures of preliminary statutory consultation for the traffic regulation orders required as described in this report. If no significant objections are received, then progress with the public advertisement and report the results to a future meeting of this Committee.
3. Instruct the appropriate officers to commence the combined statutory consultation for the traffic regulation order for the list of Blue Badge parking spaces and report back to a future meeting of this Committee.

### **3. FINANCIAL IMPLICATIONS**

The current Five Year Business Plan has identified savings from the Road Safety and Traffic Management budget. There has also been a comprehensive review of the Capital Plan which will result in proposals having to await funding for implementation.

Budget	Implementation costs (£)	Maintenance costs (£) after 5 years	Comments
(●) Cycling, Walking, Safer, Streets (Scot Gov grant-funded)	£7315	£4745	If budgets are not currently available locations will be placed on a priority list for when future funding becomes available
(■) Funded by school	Nil	Nil	Maintenance of these works falls to the school
(❖) Developer financed	Nil	£700	Maintenance of these works generally falls to the council maintenance budget when they are on-street restrictions
(➤) Disabled Parking	£200	£100	Some of these spaces will require to be relined approximately every 10 years at a cost of £100 per space and some will require removal before this time at a cost of £108 per space.

#### 4. OTHER IMPLICATIONS

There is a risk that any approved traffic regulation orders may have to re-enter the legislative process if they are unable to be implemented within the statutory implementation time of 2 years from the start of public consultation if funding is insufficient.

#### 5. BACKGROUND/MAIN ISSUES

There are 17 traffic management proposals brought forward during the course of routine examination of road safety and traffic flows.

- **The following proposals will be funded from Cycling, Walking, Safer Streets budget**

**Polmuir Road / Ferryhill Place**

Re-position of 'Residents Only' parking bay and extension of Bus Stop bay.

Concerns have been received from the Public Transport Unit (PTU) that buses are unable to utilise the full length of the bus stop at the north end of Polmuir Road due to there being one 'Pay & Display' bay directly adjacent which is constantly utilised given the parking pressures in the area.

Therefore it is proposed to extend the bus stop bay by 5 metres over the on-street parking bay. In order not to lose precious on-street parking facilities an additional space will be accommodated in close proximity. The location identified is on Ferryhill Place where it is proposed to extend the current 'Residents Only' parking bay by 5 metres to compensate for the loss of the space on Polmuir Road.

A plan of the proposals is shown in Appendix 1 of this report.

Implementation cost - £100

Estimated maintenance cost - £100 every 5 years

Ward - Torry / Ferryhill

Elected Members: Allan / Dickson / Donnelly / Kiddie

**Walker Road / Grampian Place**

Revocation of existing 'At any time' waiting restrictions

Following the closure of Craiginches Prison, residents of the neighbouring streets have requested that specific lengths of 'At any time' waiting restrictions, which were implemented as a requirement for when the prison was in operation, be removed to allow for additional on-street parking.

It is proposed to revoke specific lengths of restrictions on both Walker Road and Grampian Place.

A plan of the proposals is shown in Appendix 2 of this report.

Removal cost - £1500

Estimated maintenance cost - £ N/A

Ward - Torry / Ferryhill

Elected Members: Allan / Dickson / Donnelly / Kiddie

## **Frederick Street Car Park**

Proposed introduction of 1 hour short stay parking

Given this car park's close proximity to the Aberdeen Health Village a majority of its users are patients attending appointments at the Health Village, the appointments can vary in duration with many of them as short as 30 minutes. This has led to requests for a change in the current charging hours within this short stay car park.

Therefore it is proposed to introduce charges for 1 hour short term parking within Frederick Street Car Park, this would be in-line with the similar situation that occurs in the Denburn Car Park and associated with the Denburn Health Centre.

A plan of the proposals is shown in Appendix 3 of this report.

Implementation cost – minimal staff costs  
Estimated maintenance cost – Nil

Ward - George Street / Harbour  
Elected Members: May / Jean Morrison / Nathan Morrison

## **Springfield Avenue / Springfield Road**

Proposed 'At any time' waiting restrictions

Officers have received a request to implement 'At Any Time' waiting restrictions at the junction of Springfield Avenue with Springfield Road. Due to parking pressures in the area, vehicles park in close proximity to the junction. This causes drivers turning into Springfield Avenue to drive on the wrong side of the road. There are safety implications with this current arrangement; due to a bend in the road forward visibility is poor for traffic travelling in both directions along Springfield Avenue.

Given the above it is proposed to apply lengths of prohibition of waiting at any time at this junction.

A plan of the proposals is shown in Appendix 4 of this report.

Implementation cost - £300  
Estimated maintenance cost - £300 every 5 years

Ward – Hazlehead / Ashley / Queens Cross  
Elected members – Corral / Greig / Stewart / Thomson

## **Greenfern Avenue**

Proposed 'At any time' waiting restrictions

Officers have received a request to install 'At Any Time' waiting restrictions between properties 24 and 26 Greenfern Avenue. Parking on Greenfern Avenue is at a premium and the residents of 26 Greenfern Avenue have had

severe difficulty with access to and from their driveway; there have been a number of collisions as a consequence. An 'H' bar marking was previously implemented across the driveway of property no. 26; this has not resolved the issue and resulted in a prolonged period of abuse. A length of 'At Any Time' waiting restriction is proposed to prevent vehicles from parking on the short section (3 metres) between the driveways of the two properties.

A plan of the proposals is shown in Appendix 5 of this report.

Implementation cost - £40

Estimated maintenance cost - £40 every 5 years

Ward – Kingswells / Sheddocksley / Summerhill

Elected members – Cameron / Delaney / Ironside

### **Auchinleck Crescent**

Proposed 'At any time' waiting restrictions

Concerns have been expressed by residents with regard to vehicles being parked on the north side of Auchinleck Crescent at either side of the access to the residents' car park. This parking occurs on a bend where visibility is poor; the issue is that vehicles exiting the car park do so unable to see oncoming vehicles. The parking is associated with the nearby multi-storey developments and residents have real concerns as to the potential for a collision to occur due to this parking.

Given the above it is proposed to apply lengths of prohibition of waiting at any time at this junction.

A plan of the proposals is shown in Appendix 6 of this report.

Implementation cost - £300

Estimated maintenance cost - £300 every 5 years

Ward – Tillydrone / Seaton / Old Aberdeen

Elected members – Grant / Milne / Noble

### **Forest Avenue Lane**

Proposed 'At any time' and 'No waiting Mon – Fri, 10am to 4pm' restrictions

Concerns have been expressed by residents with regard to vehicles being parked on both sides of the junction of Forbesfield Road and Forest Avenue Lane and within the lane from which residents take access to their garages. The results are that residents have difficulty accessing and exiting their garages, whilst visibility is obscured at the exit of the lane onto Forbesfield Road. The parking is by teaching staff from nearby Albyn School and is limited to school hours.

Given the above it is proposed to apply lengths of prohibition of waiting, both 'at any time', and 'between 10am and 4pm, Monday to Friday'.

A plan of the proposals is shown in Appendix 7 of this report.

Implementation cost - £700  
Estimated maintenance cost - £700 every 5 years

Ward – Hazlehead / Ashley / Queens Cross  
Elected members – Corrall / Greig / Stewart / Thomson

### **Thistle Lane**

Proposed 'At any time' waiting restrictions

Officers received a request from a local resident to replace the current '8 – 6' waiting restrictions with 'At Any Time' restrictions on Thistle Lane. These measures are required to assist residents with access to garages and off-street car parking areas. Emergency vehicles / delivery vehicles would have difficulty accessing properties, if cars were parked in the lane. Buildings at the junction of Margaret Street and Thistle Lane have also been damaged due to vehicles turning into Thistle Lane trying to pass parked cars. A car parking survey was undertaken during the evening, it was found that four cars were parked blocking through access for larger vehicles.

'At Any Time' waiting restrictions are also proposed on Thistle Street at its junction with Thistle Lane. Cars currently park close to the junction with Thistle lane which can cause problems with visibility when turning from Thistle Lane onto Thistle Street.

A plan of the proposals is shown in Appendix 8 of this report.

Implementation cost - £1300  
Estimated maintenance cost - £1300 every 5 years

Ward – Midstocket / Rosemount  
Elected members – Forsyth / Laing / Cormie

### **Stronsay Drive**

Proposed 'At any time' waiting restrictions

Officers have received a number of complaints from local Councillors and constituents who travel along Stronsay Drive; regarding vehicles parking adjacent to the build out opposite Fernielea Crescent causing visibility issues for other road users. It is therefore proposed to implement "At any time" waiting restrictions on Stronsay Drive and Fernielea Crescent to resolve the issue. It is anticipated that parents of children at Fernielea Primary School will park in the slip road opposite the school while visitors to Summerhill Parish Church will park in Fernielea Crescent outwith the new restrictions. Following implementation of these measures it is proposed to reassess the site. If further measures are required these shall be included in a future report to committee. Police Scotland have been involved with this issue and support the recommendations.

A plan of the proposals is shown in Appendix 9 of this report.

Implementation cost - £1200  
Estimated maintenance cost - £1200 every 5 years

Ward – Hazlehead / Ashley / Queens Cross  
Elected members – Corral / Greig / Stewart / Thomson

### **Carnegie Crescent / Anderson Drive**

Proposed 'At any time' waiting restrictions.

Reports have most recently been received from residents via Councillor Greig and Councillor Thomson that vehicles are being parked indiscriminately on the junction of Carnegie Crescent and the Anderson Drive slip road, and in doing so, are causing an obstruction and obscuring visibility. These reports come further to reports received via Councillor Stewart regarding the same issue.

Subsequent to the original reports having been received, officers observed that the problem of indiscriminate parking at this location had subsided, so proposals for the implementation of formal waiting restrictions were not progressed at that time. Following recent reports, it is evident that this problem has returned, so it is proposed to introduce junction protection in the form of "At any time" waiting restrictions at this junction.

A plan of the proposals is shown in Appendix 10 of this report.

Implementation cost - £125  
Estimated maintenance cost - £125 every 5 years

Ward - Hazlehead / Ashley / Queens Cross  
Elected Members - Corral / Greig / Stewart / Thomson

### **A944, between Kingswells and Westhill**

Proposed reduction of speed limit from 50mph to 40mph and introduction of shared cycleway / footway.

As a result of the new signalised junction replacing the existing roundabout on the A944, Aberdeen to Alford road at Westhill, it is considered that a new reduced speed limit of 40mph be introduced to replace the existing 50mph limit within the vicinity of the junction for road safety reasons.

Due to the proposed further development along this corridor as well as the AWPR interchange, it is proposed that this opportunity is taken to reduce the speed limit to 40mph on the section of road between the roundabout at Westhill and the new 40mph speed limit at the Ardene House Veterinary Hospital. Reducing the speed limit to 40mph will decrease the number of changes along this section of road, therefore causing less confusion for motorists.

The proposed 40mph speed limit will compliment the existing speed limits within the Aberdeenshire road network and has been discussed in detail with officers from the neighbouring authority.

A new shared cycleway / footway link on the A944 and B9119 into the new development has also been agreed. The sections on the B9119 and A944 within the boundary of Aberdeen City Council will be included within the Traffic Regulation Order. This will tie into the section on the A944 within Aberdeenshire Council's jurisdiction, which will be included within their Traffic Regulation Order.

A plan of the proposals is shown in Appendix 11 and 12 of this report.

Implementation cost - £600

Estimated maintenance cost - £150 every 5 years

Wards – Kingswells / Sheddocksley / Summerhill  
Lower Deeside

Elected members – Cameron / Delaney / Ironside  
Boulton / Malik / Malone

### **Rosemount Place**

Proposed 'No Loading 07:30 to 09:30 and 15:30 to 18:30' restrictions

Officers received a request from a local resident in regard to vehicles parking on the existing 'At Any Time' waiting restrictions at the junction of View Terrace and Rosemount Place. Vehicles parked at this location are both obscuring visibility for vehicles exiting View Terrace onto Rosemount Place and restricting vehicles movements along Rosemount Place. The rogue parking can be split into two categories: commuters stopping briefly to utilise the local convenience stores and fast food outlets and large delivery vehicles parking for extended periods to deliver supplies to the local businesses. As rogue parking by the delivery vehicles is a major factor in the issues highlighted, it is proposed to restrict deliveries to times out-with peak periods to alleviate some of the problems. It is therefore proposed to introduce 'No Loading 07:30 to 09:30 and 15:30 to 18:30' restrictions on both View Terrace and a section of Rosemount Place between Short Loanings and Richmond Street. This is to ensure the parking issue is not merely shifted from one location to another.

Plans of the proposals are shown in Appendix 13 of this report.

Implementation cost - £700

Estimated maintenance cost - £350 every 5 years

Ward – Midstocket / Rosemount

Elected members – Forsyth / Laing / Cormie

### **North Deeside Road, Cults**

Proposed 'At any time' waiting restrictions and relocation of on-street parking

A new Community Outreach Centre recently opened at the site of the former Cults East Parish Church. In the lead up its opening there has been ongoing



dialogue between representatives for the Outreach Centre and both Councillor Malone, and Councillor Boulton, with regard to on-street parking within the vicinity of the centre. As a result, representatives for the Outreach Centre enquired as to the possibility of relocating existing on-street parking on the south side of the North Deeside Road to the north side. The rationale for the suggestion was the majority of on-street parking at this location is associated with the Outreach Centre and the relocation would therefore allow drivers and passengers, particularly those of limited mobility/disabled, direct access to the northern footway without having to cross the busy North Deeside Road. On considering this suggestion, it was found on-street parking capacity for the same number of vehicles as currently accommodated on the south side could be created on the north side. It is therefore proposed to promote a new length of prohibition of waiting at any time on the south side and revoke existing lengths on the north side.

Of note, is a certain length of the existing waiting restriction on the north side was introduced by way of a temporary order in 2013. At this point vehicles were able to park on both sides of the road and as a result it was often the case only a single file of traffic could pass thereby leading to delay and congestion for vehicles on this route. The aforementioned being particularly relevant when considering the numerous larger vehicles such as buses and HGVs that use this route. This proposal would therefore establish permanently a Traffic Order that prevents general on-street parking on both sides of the North Deeside Road at this location.

A plan of the proposal is shown in Appendix 14.

Implementation cost - £450

Estimated maintenance cost – £180 every five years (albeit, not an additional burden as this proposal is relocating an existing length of 'double yellow' lines)

Ward – Lower Deeside

Elected Members - Boulton, Malone, Tauqeer Malik

▪ **The following proposal will be funded by the school**

**Cults Primary School**

Proposed regulatory traffic management restrictions

There have been on-going concerns expressed with regard to parking on the perimeter road serving Cults Primary School and Nursery. In an effort to mitigate these issues in the past the School has installed measures such as 'double yellow' lines and a parking place for buses; while also providing dedicated disabled parking places. There is also an established one-way system in operation on the road. However, the road is privately maintained by the School and as a result a Traffic Regulation Order was never promoted that would allow these existing restrictions to be enforced. As a result, it is now proposed to promote a Traffic Regulation Order that would allow these restrictions to be enforced. Albeit, the opportunity has been taken to review

the perimeter road and it is therefore proposed to both modify existing restrictions and introduce new measures that include a School Keep Clear, a dedicated parking place for taxis, a length of prohibition of waiting at any time that will function as a drop off/pick up point for cars and buses, and additional disabled parking places.

A plan of the proposals is shown in Appendix 15.

The school will meet the approximate £1500 cost of installing these measures and also maintain the signs and road markings in future years.

Ward – Lower Deeside

Elected Members: Boulton, Malone, Tauqeer Malik

### ❖ **The following proposals will be funded by the developer / business**

#### **Tarbothill Road, Bridge of Don**

Proposed revocation of 'School Keep Clear' waiting restrictions

Following the closure of Balgownie Primary School, 'School Keep Clear' waiting restrictions were left in place for use by a community nursery school. The site is now currently being developed as a residential site. It is therefore proposed to revoke the entire lengths of 'School Keep Clear' waiting restriction on Tarbothill Road.

A plan of the proposals is shown in Appendix 16 of this report.

Removal cost - £ N/A

Estimated maintenance cost - £ N/A

Ward – Bridge of Don

Elected members – Jaffrey / Reynolds / Stuart / Young

#### **Wellington Circle**

Proposed 'At any time' waiting restrictions

A developer has requested that 'At Any Time' waiting restrictions be installed around two new accesses to FMC technologies. Vehicles parked in these areas could obstruct vehicle movements and/or impede visibility splays when taking road safety into consideration.

A plan of the proposals is shown in Appendix 17 of this report.

Implementation cost – £ N/A

Estimated maintenance cost – £300 every 5 years

Ward – Kincorth / Nigg / Cove  
Elected Members – Cooney / Finlayson / McCaig

### **Earns Heugh Road**

Proposed 'At any time' waiting restrictions

As part of the Construction Consent for the development of a new neighbourhood shop 'At Any Time' waiting restrictions are required. The waiting restrictions proposed are to protect the newly formed access to the shop as well as sections of Earns Heugh Road, Loriston Avenue and Loriston Close from vehicles parking. Vehicles parking in these areas could obstruct visibility and vehicle movements.

A plan of the proposals is shown in Appendix 18 of this report.

Implementation cost – £ N/A  
Estimated maintenance cost – £400 every 5 years

Ward – Kincorth / Nigg / Cove  
Elected Members – Cooney / Finlayson / McCaig

### ➤ **The following proposals will be funded from the Disabled Parking Revenue budget**

#### **Disabled parking bays to be provided through the Disabled Persons Parking Places (Scotland) Act 2009**

There is one application to be considered at this meeting.  
*(Plans are not included as, under normal circumstance, spaces are located close to the properties.)*

#### **On-street parking** – 1 space

24 Elmfield Avenue	
--------------------	--

#### **Off-street parking** – 1 space

26a Rowan Road	
----------------	--

## **6. IMPACT**

This report meets with the local Community Plan objectives to continually improve road safety and maximise accessibility for pedestrians and all modes of transport.

The proposals are in line with the Councils Transportation Strategy to improve safety for all road users by continuing to reduce the number of casualties in traffic collisions.

This report is likely to be of interest to the public in the streets affected by the proposals.

There is no Equality and Human Rights Impact Assessment required as this report only recommends that these proposals progress to the Statutory Consultation process therefore there will be no changes effected as a result of the recommendations being approved by the Committee.

## 7. BACKGROUND PAPERS

None

## 8. REPORT AUTHOR DETAILS

Katherine Duncan  
Technical Officer  
[kathduncan@aberdeencity.gov.uk](mailto:kathduncan@aberdeencity.gov.uk)  
(01224) 538029

Michael Cowie  
Engineering Assistant  
[micowie@aberdeencity.gov.uk](mailto:micowie@aberdeencity.gov.uk)  
(01224) 538050

## 9. CONSULTEES COMMENTS

Enterprise, Strategic Planning and Infrastructure Committee  
**Convener: Councillor Barney Crockett – emailed 10 February 2014**  
**Vice Convener: Councillor Angela Taylor – emailed 10 February 2014**

---

### Councillors

---

Councillor Sandy Stuart was consulted on 10 February 2014

---

Councillor Willie Young was consulted on 10 February 2014

---

Councillor Muriel Jaffray was consulted on 10 February 2014

---

Councillor John Reynolds was consulted on 10 February 2014

---

Councillor David Cameron was consulted on 10 February 2014

---

Councillor Steve Delaney was consulted on 10 February 2014

---

Councillor Len Ironside was consulted on 10 February 2014

---

Councillor Ross Grant was consulted on 10 February 2014

---

Councillor Ramsay Milne was consulted on 10 February 2014

---

Councillor Jim Noble was consulted on 10 February 2014

---

Councillor Bill Cormie was consulted on 10 February 2014

---

Councillor Fraser Forsyth was consulted on 10 February 2014

---

Councillor Andrew May was consulted on 10 February 2014

---

Councillor Jean Morrison was consulted on 10 February 2014

---

Councillor Nathan Morrison was consulted on 10 February 2014

---

Councillor Marie Boulton was consulted on 10 February 2014 and commented that for the North Deeside Road, Cults clarification was needed to ensure that there wasn't a reduction on the number of parking spaces outside the Community Outreach Centre. A response was sent on 13 February 2014 which outlined that whilst 5 spaces had been lost when the temporary 'AAT' order was introduced; no further spaces would be lost in either the repositioning of the parking spaces or introduction of the permanent 'AAT' waiting restrictions.

Councillor M Tauqeer Malik was consulted on 10 February 2014

Councillor Aileen Malone was consulted on 10 February 2014

Councillor Jennifer Laing was consulted on 10 February 2014

Councillor Yvonne Allan was consulted on 10 February 2014

Councillor Graham Dickson was consulted on 10 February 2014

Councillor Alan Donnelly was consulted on 10 February 2014

Councillor Callum McCaig was consulted on 10 February 2014

Councillor James Kiddie was consulted on 10 February 2014

Councillor Neil Cooney was consulted on 10 February 2014

Councillor Andrew Finlayson was consulted on 10 February 2014

Councillor Martin Greig was consulted on 10 February 2014

Councillor Jennifer Stewart was consulted on 10 February 2014

Councillor Ross Thomson was consulted on 10 February 2014

Councillor John Corral was consulted on 10 February 2014

#### Council Officers

Lorna Inglis, Secretary to Head of Finance was consulted on 10 February 2014. Brian Downie, Finance Manager responded on behalf of the service and commented "A944 Kingswells to Westhill – would there not be an initial cost involved in replacing signage?" a response was sent on the 17 February 2014 stating that although the majority of the cost would be covered by the developer, the cost of the repeater signs for the A944 had been overlooked. The cost of these signs is estimated to be around £600 and will be funded from the Cycling, Walking, Safer Streets budget. This cost estimation has been amended in this report.

Jane MacEachran, Head of Legal and Democratic Services, Corporate Governance was consulted on 10 February 2014

Ciaran Monaghan, Head of Service, Office of Chief Executive was consulted on 10 February 2014

Gordon McIntosh, Director of Enterprise, Planning and Infrastructure was consulted on 10 February 2014

Hugh Murdoch, Head of Asset Management and Operations, Enterprise, Planning and Infrastructure was consulted on 10 February 2014

Margaret Bochel, Head of Planning & Sustainable Development, Enterprise, Planning and Infrastructure was consulted on 10 February 2014 and is in agreement on the contents of this report.

Mike Cheyne, General Manager Operations, Enterprise, Planning and Infrastructure was consulted on 10 February 2014 and commented that the 'AAT' waiting restrictions on Stronsay Drive should be extended to cover both sides of the road to prevent displaced vehicles causing issues on the west side of Stronsay Drive. The plan has been amended to reflect this change.

---

Neil Carnegie, Community Safety Manager, Housing and Environment was consulted on 10 February 2014. A response was received in regard Frederick Street car park; the comment was in relation to parking for council employees and has no impact on the contents of this report.

---

David Young, Account Manager, Corporate Governance was consulted on 10 February 2014

---

- **The following proposals will be funded from Cycling, Walking, Safer Streets budget**

Appendix 1

**Polmuir Road / Ferryhill Place - Bus Stop Extension & Residents Only Parking Bay Extension**

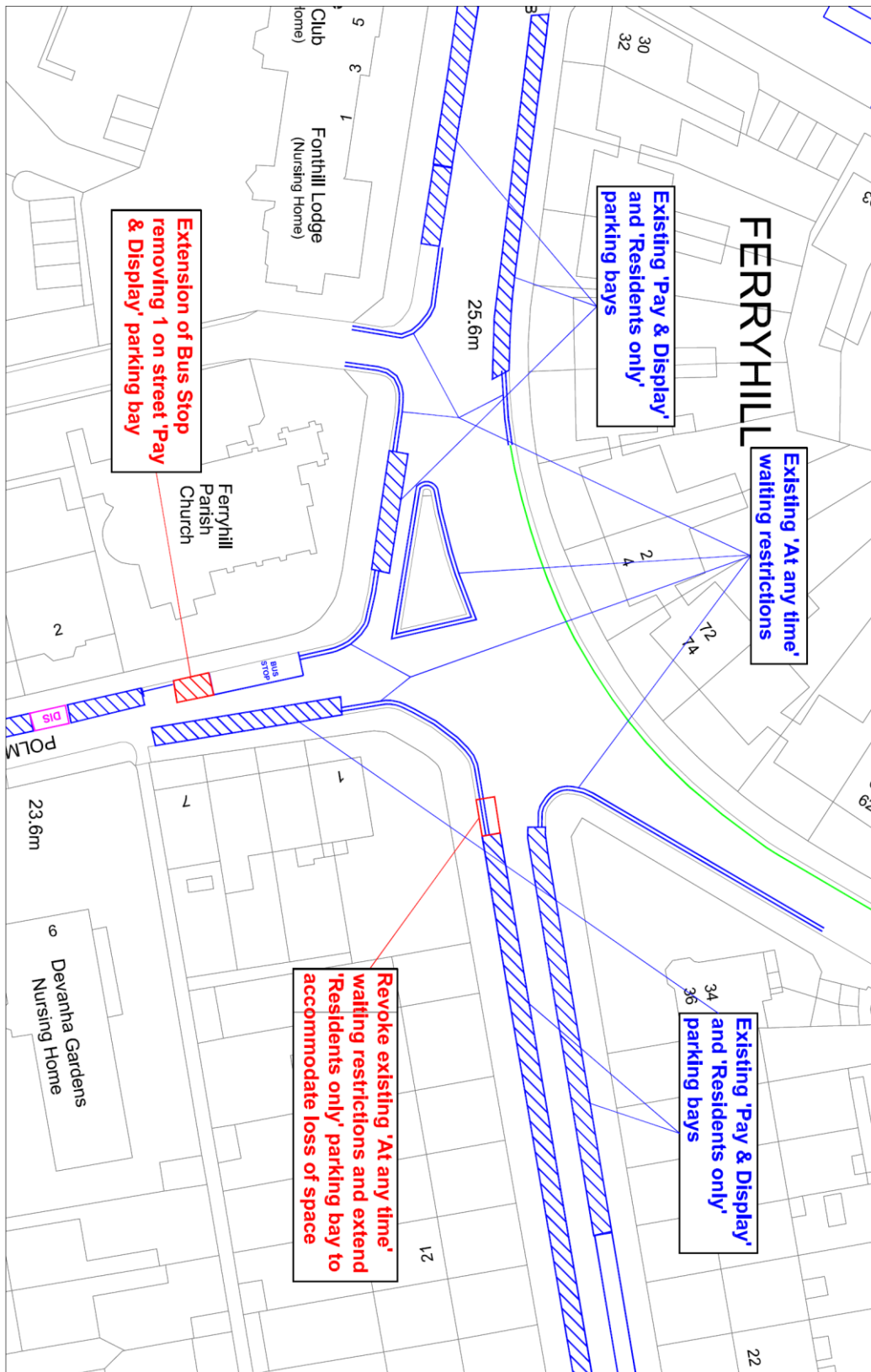





**Frederick Street Car Park - Proposed 1 hour parking**

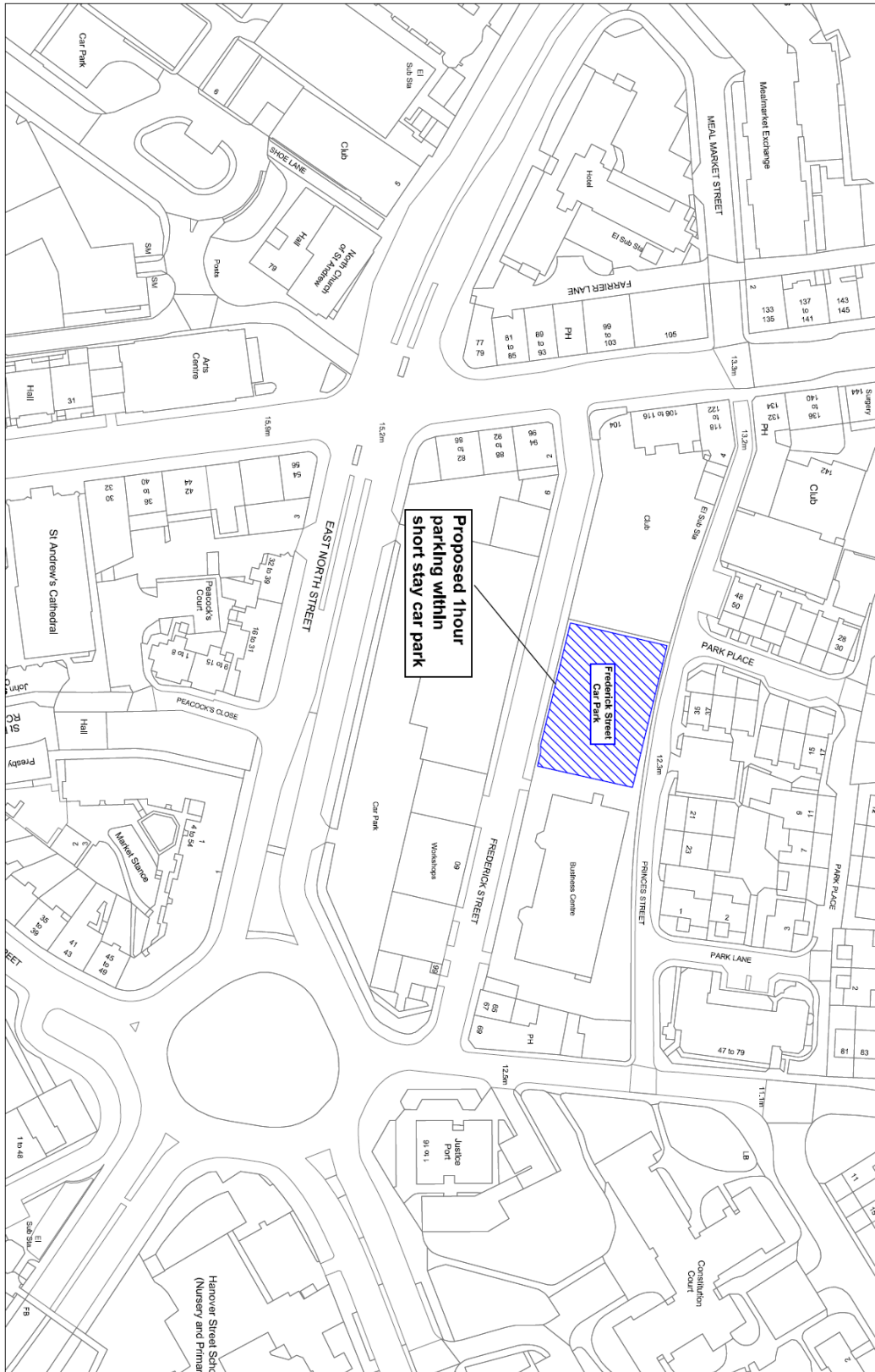

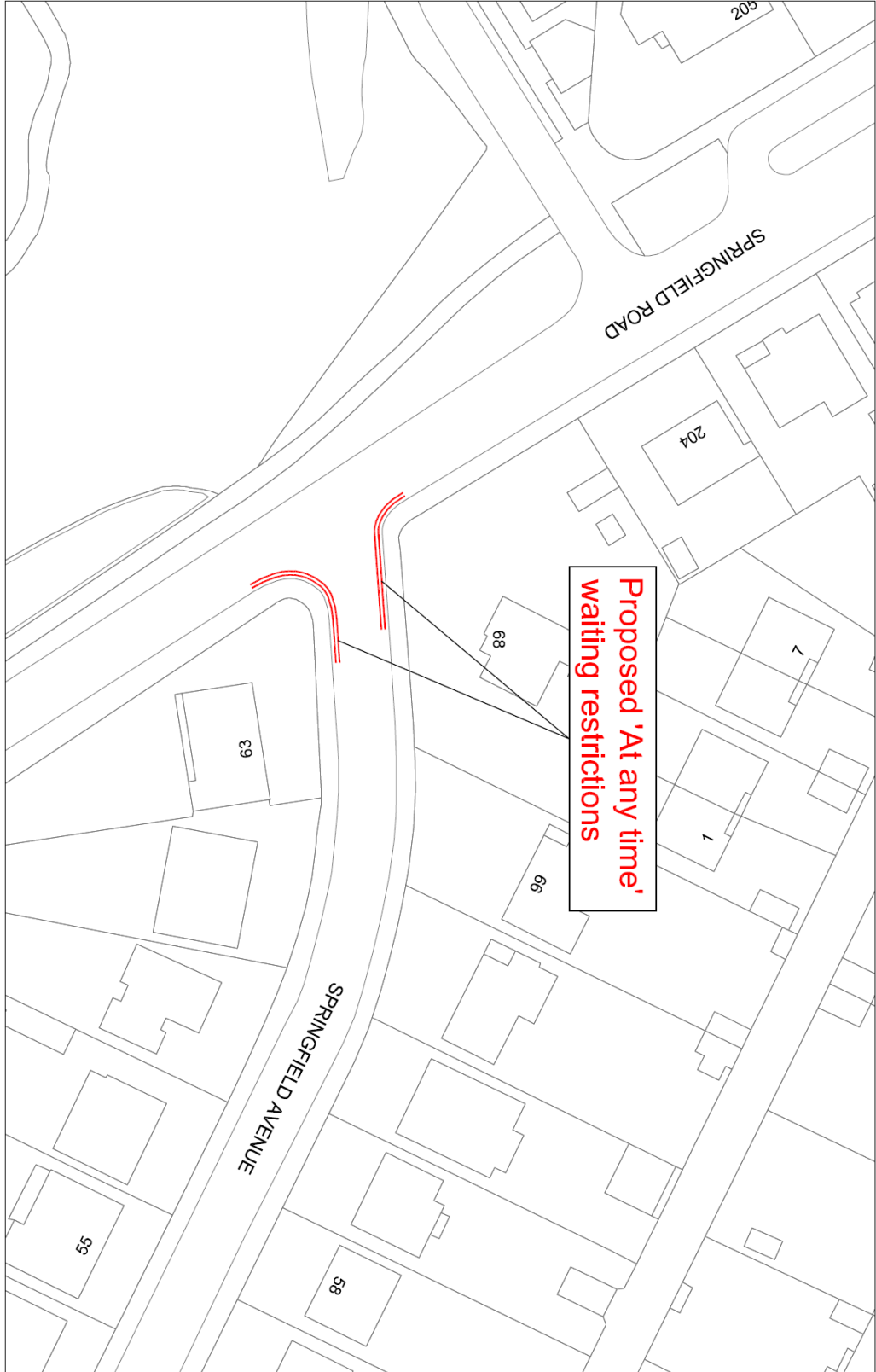

**Springfield Avenue - Proposed 'At any time' waiting restrictions**

**Greenfern Avenue - 'At Any Time' waiting restrictions**

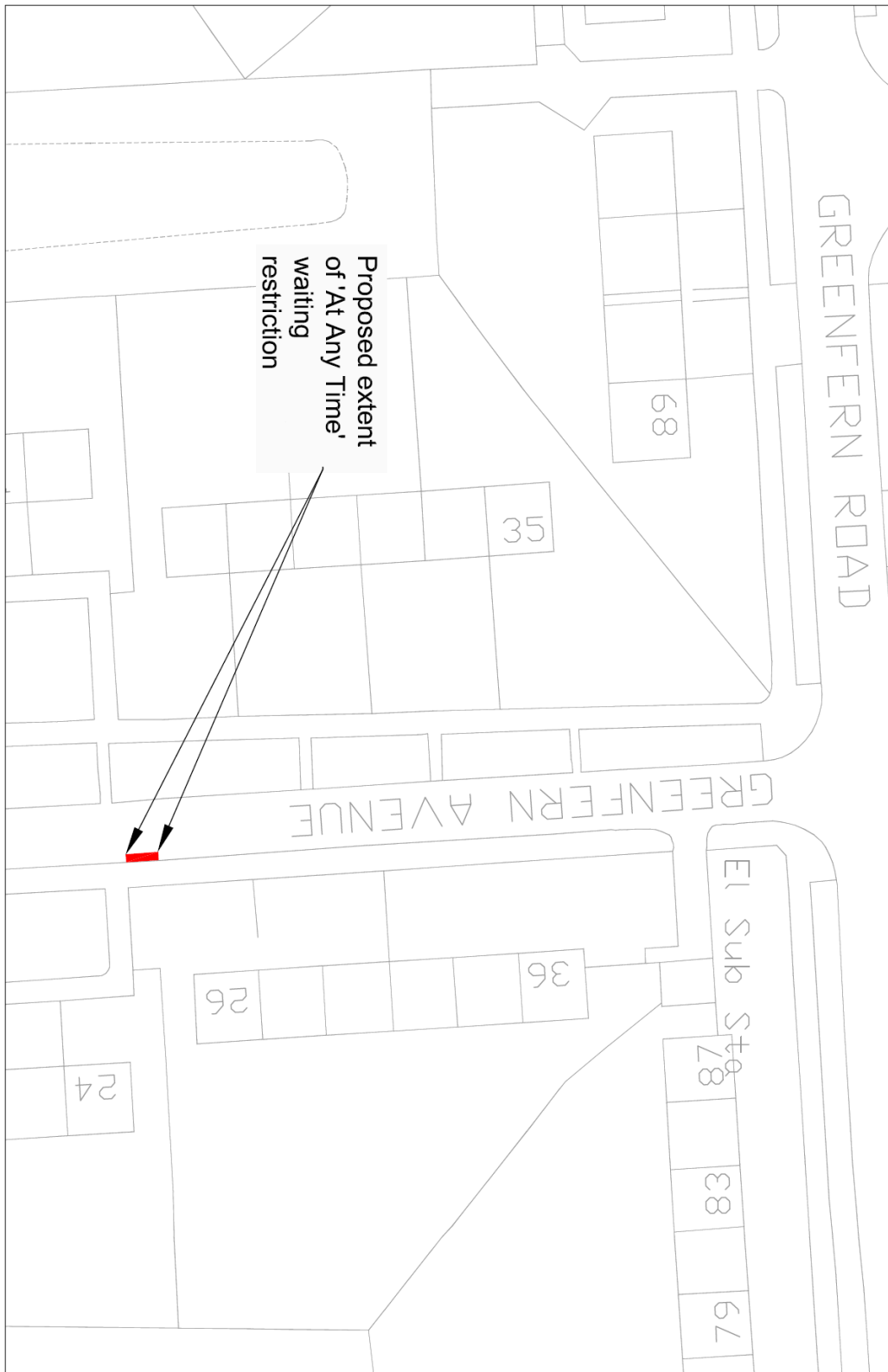

# Appendix 6

## Auchinleck Crescent

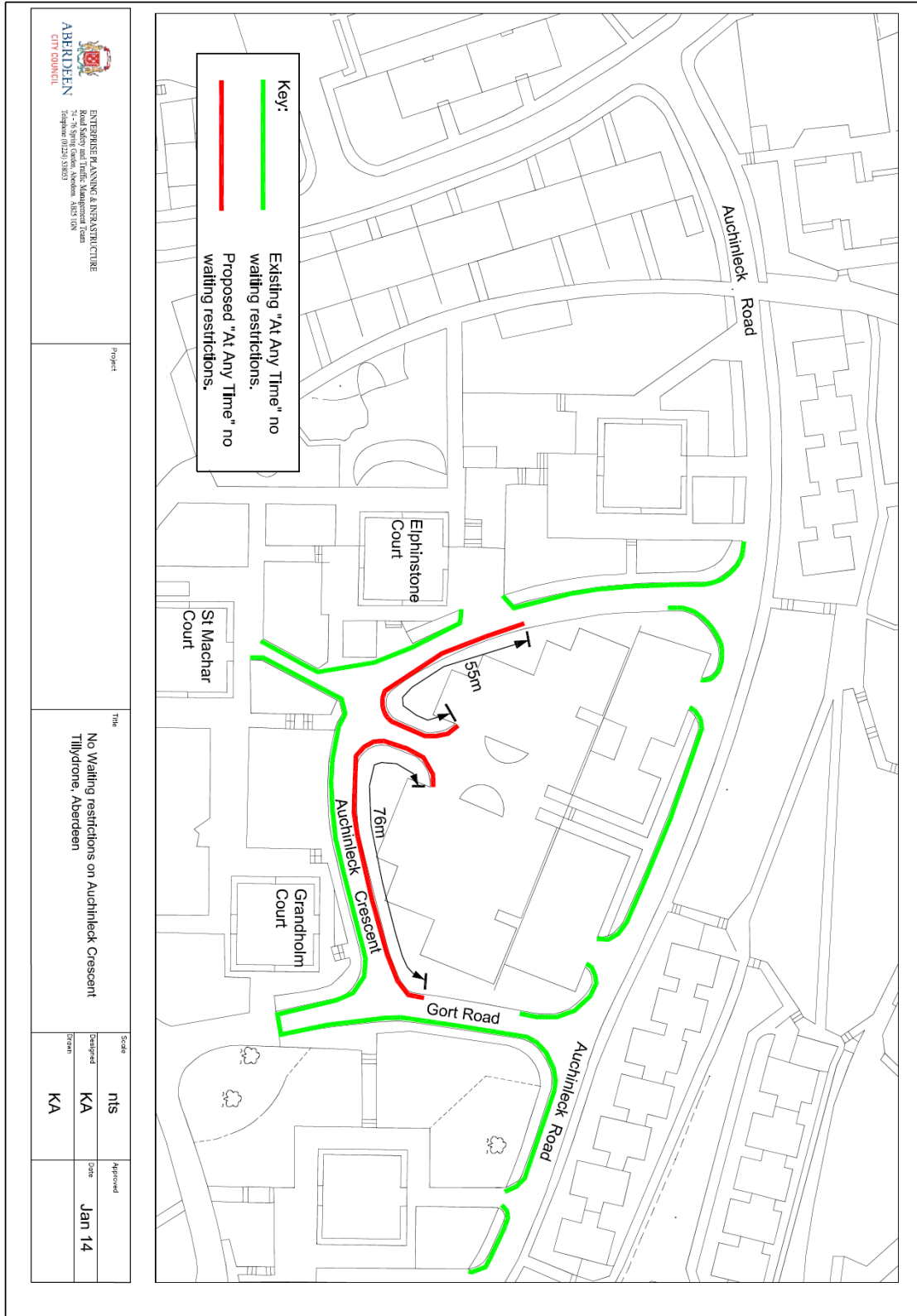

  
**ENTERPRISE PLANNING & INFRASTRUCTURE**  
 11, 12 & 13, Market Street  
 Aberdeen, AB9 1SN  
 Telephone: 01224 558833

Project

Title

No Waiting restrictions on Auchinleck Crescent  
Tillydrone, Aberdeen

Scale		Approved
Designed	nts	
Drawn	KA	
	KA	
		Date
		Jan 14

# Appendix 7

## Forest Avenue Lane / Forbesfield Road

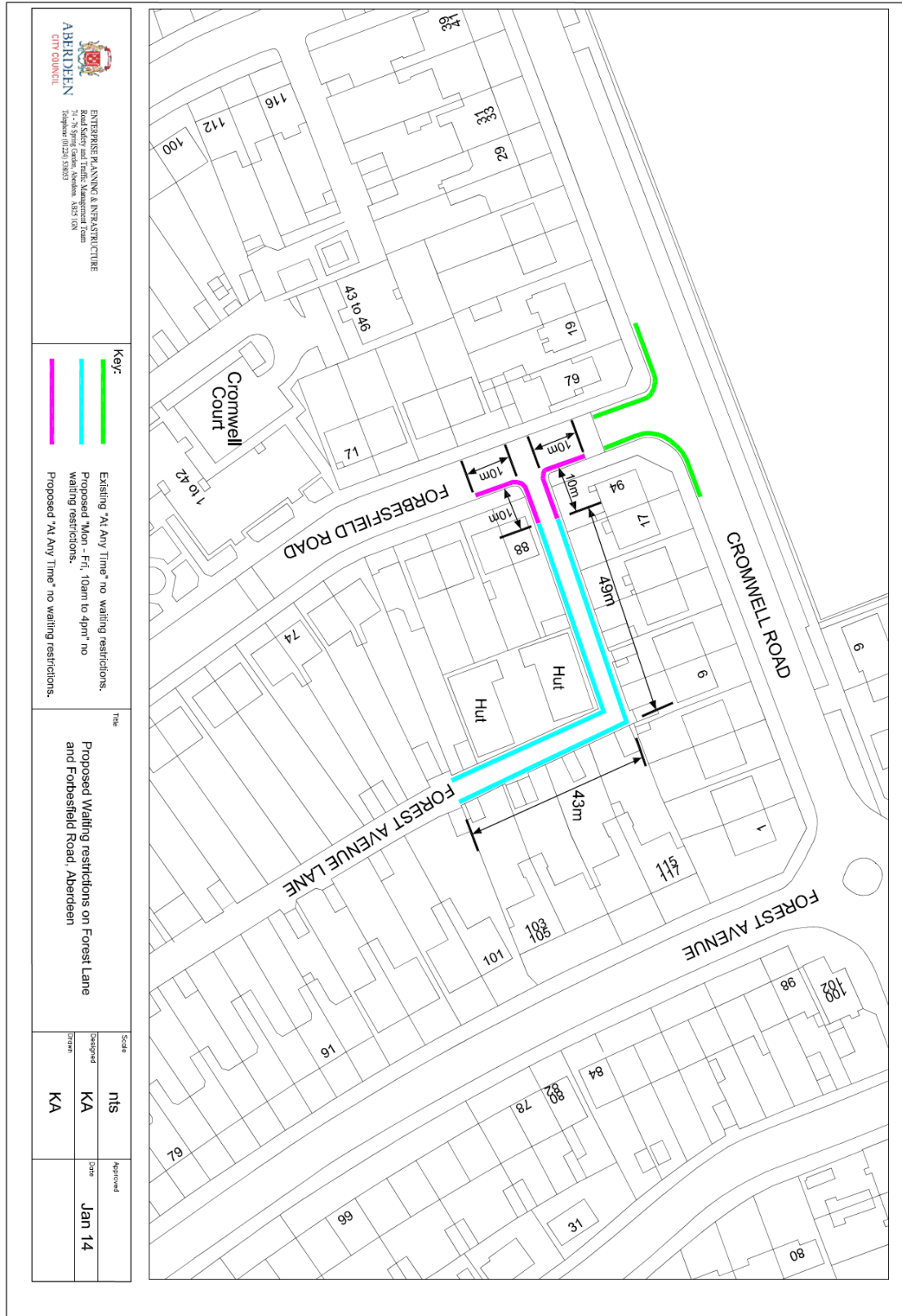

**ABERDEEN CITY COUNCIL**  
**ENTERPRISE PLANNING & INFRASTRUCTURE**  
 Road Safety and Traffic Management Team  
 74 - 76 Spring Garden, Aberdeen, AB25 1DN  
 Telephone: 01224 538033

Key:	
	Existing 'At Any Time' no waiting restrictions.
	Proposed 'Mon - Fri, 10am to 4pm' no waiting restrictions.
	Proposed 'At Any Time' no waiting restrictions.

**Title**  
 Proposed Waiting restrictions on Forest Lane and Forbesfield Road, Aberdeen

Scale	
Drawn	Approved
KA	Jan 14

# Thistle Lane - 'At Any Time' waiting restrictions

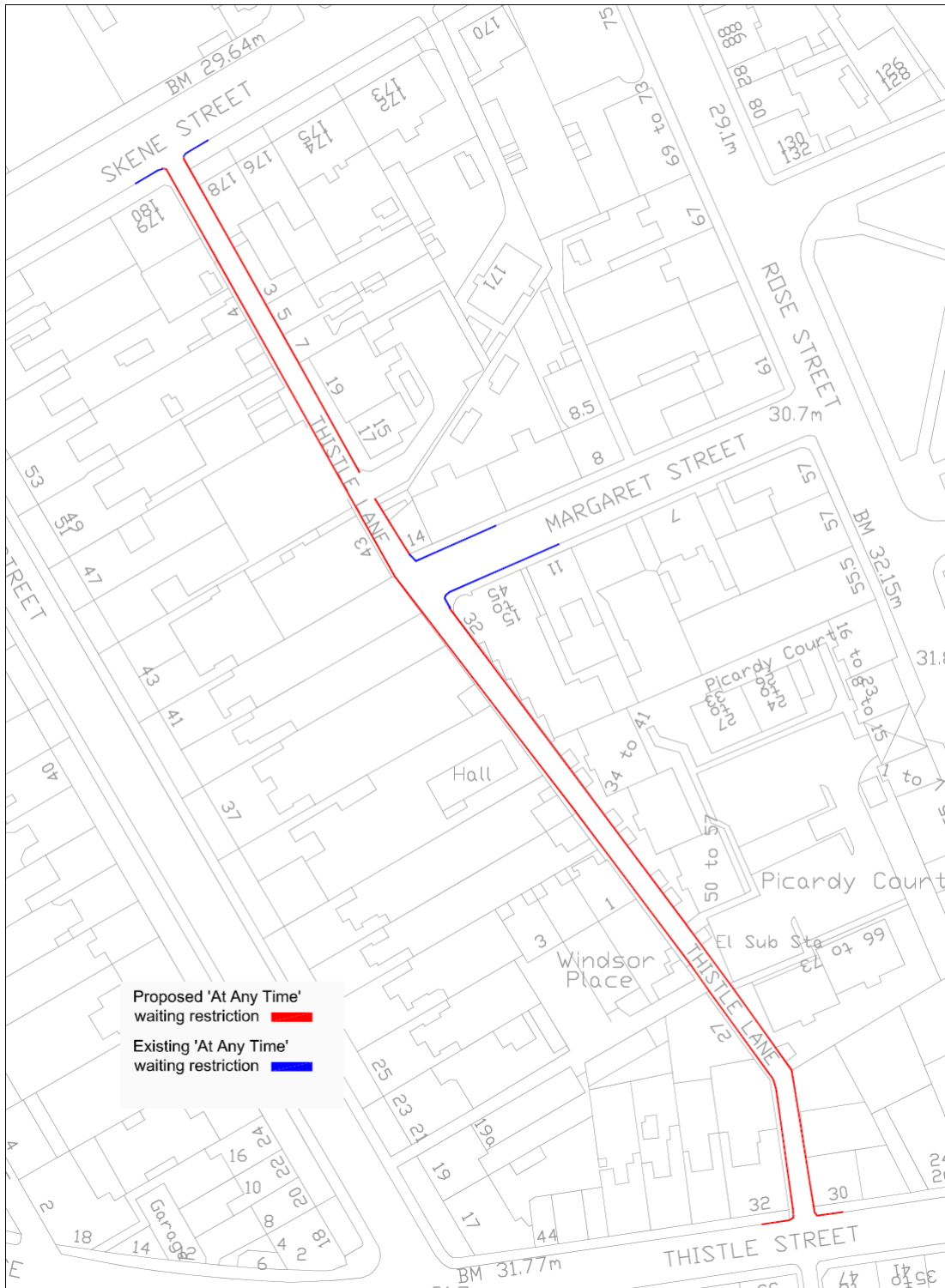

# Appendix 9

## Stronsay Drive

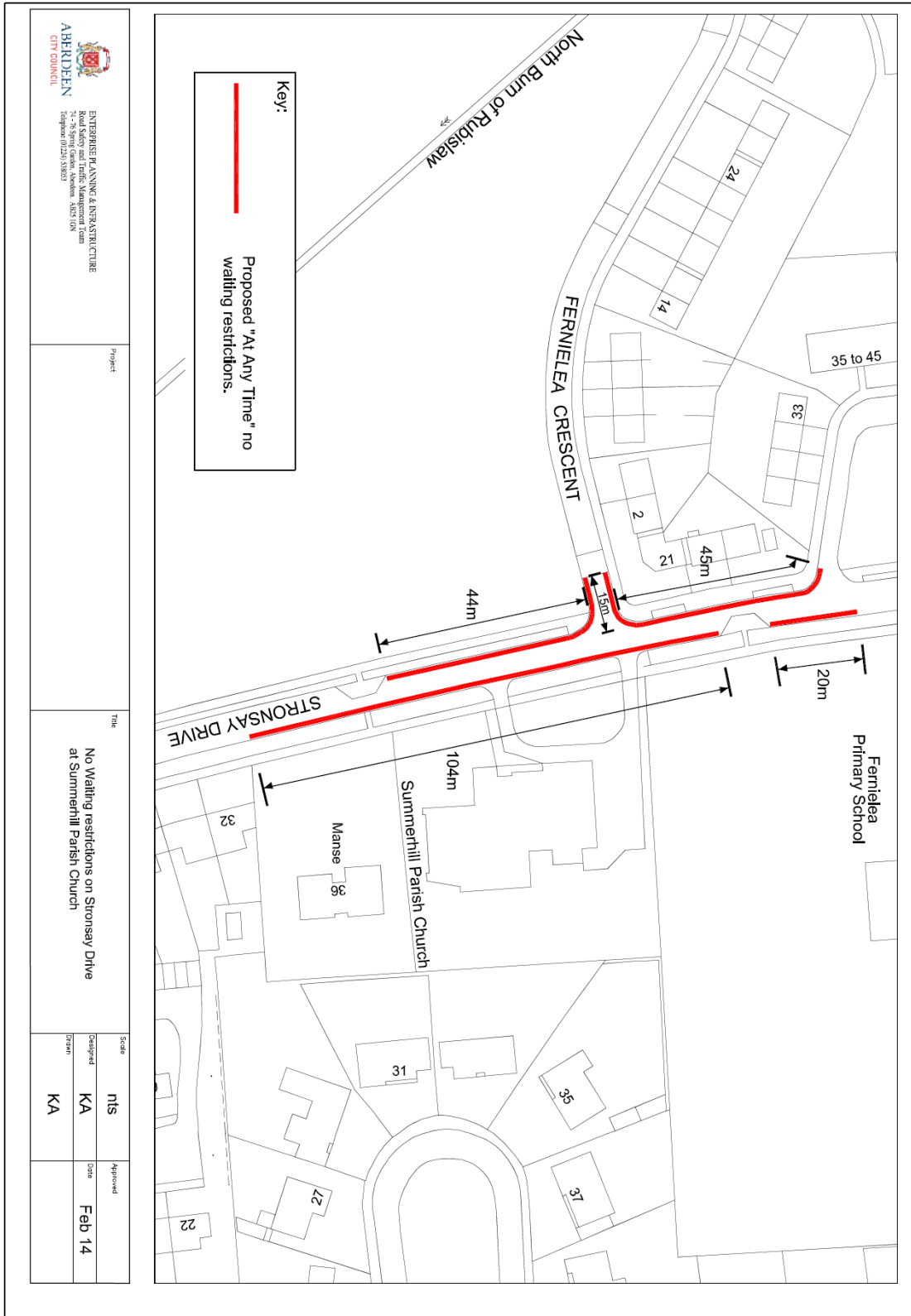





**Carnegie Crescent/Anderson Drive - Proposed "At any time" waiting restrictions**



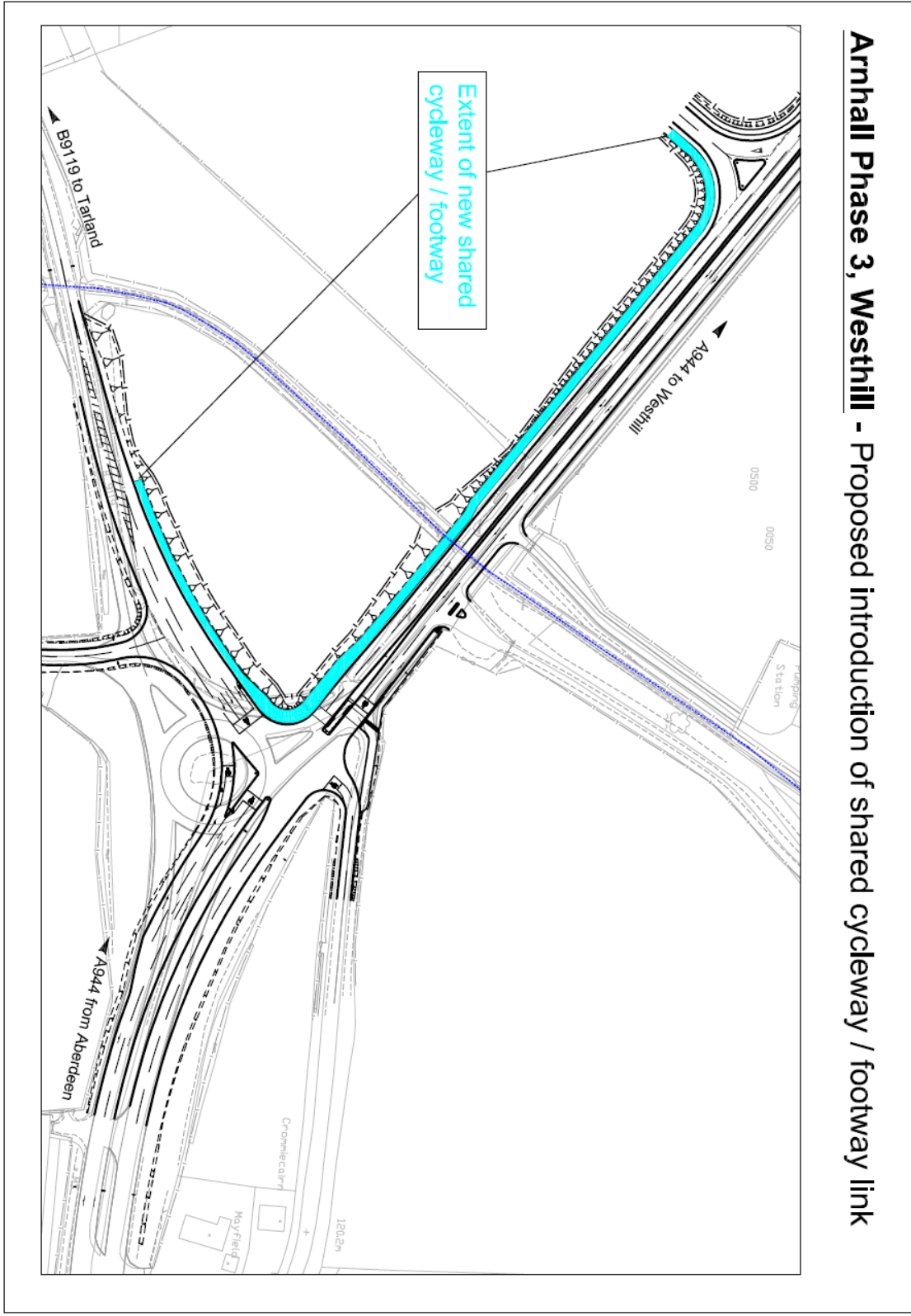

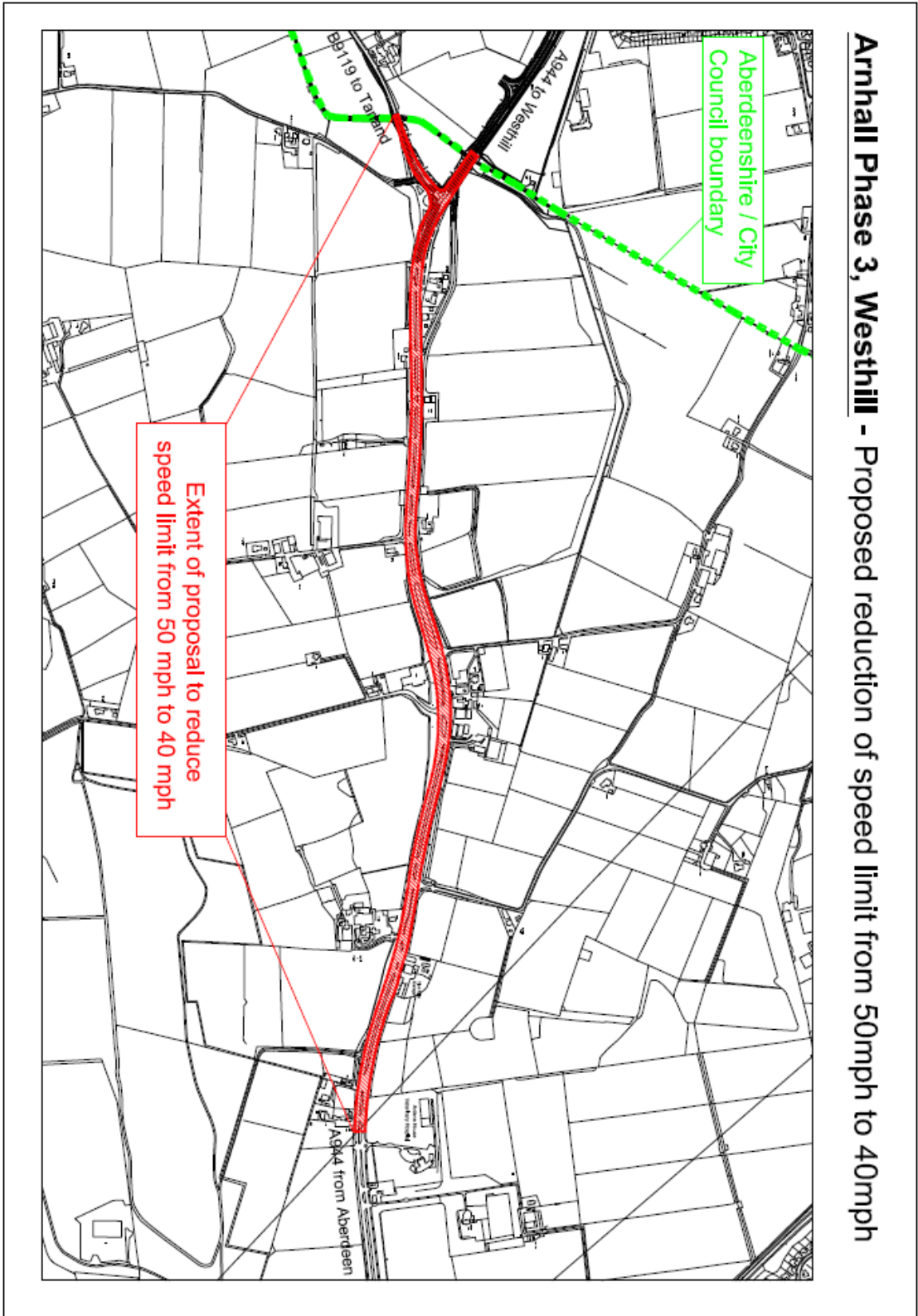

Proposed 'No Loading' restrictions on Rosemount Place, Aberdeen

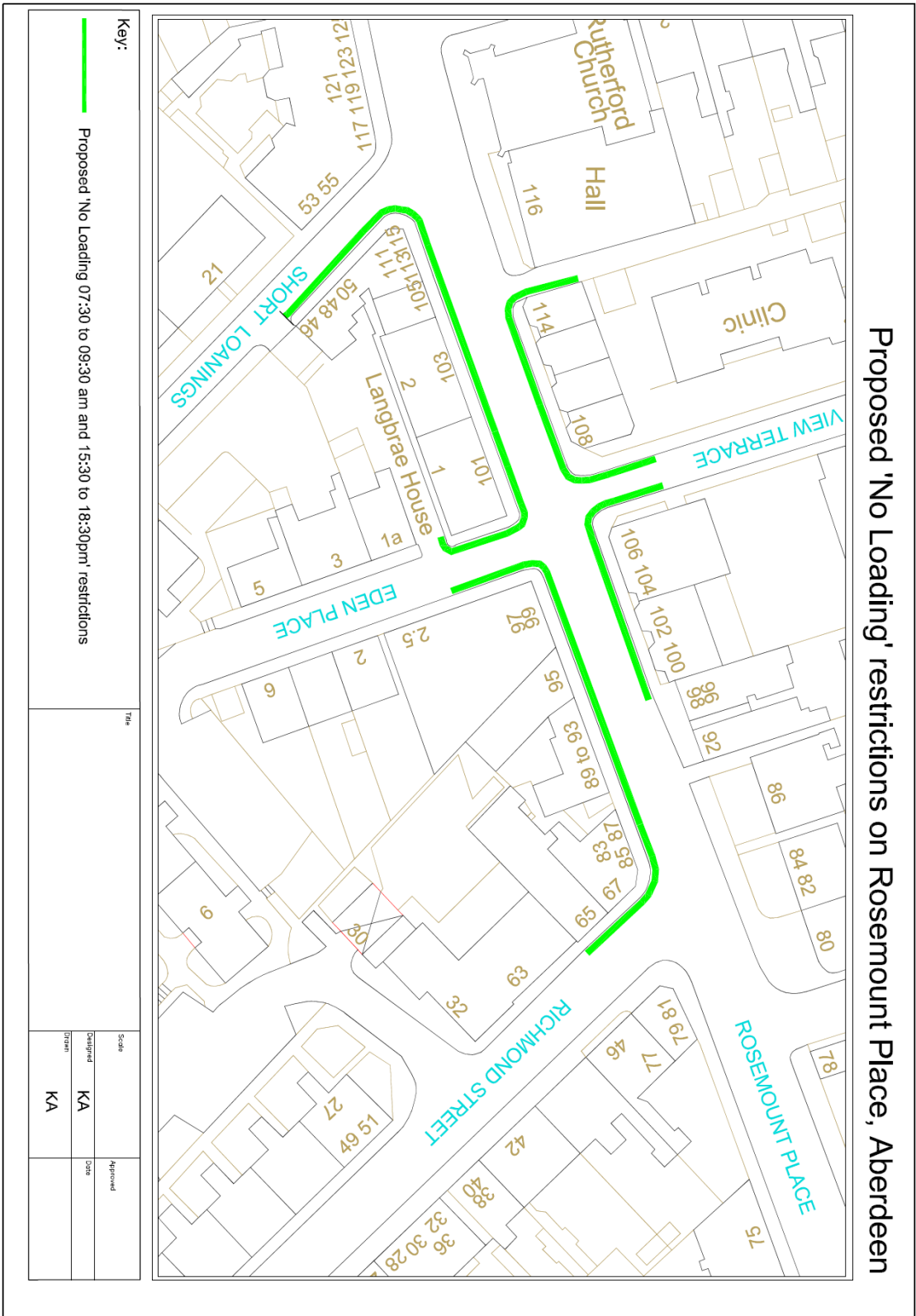

Key:

Proposed 'No Loading' 07:30 to 09:30 am and 15:30 to 18:30pm' restrictions

Title		Scale		Approved	
Designed	KA	Drawn	KA	Date	
	KA		KA		



■ **The following proposal will be funded by the school**

Appendix 15

**Cults School - Proposed regulatory traffic management restrictions**

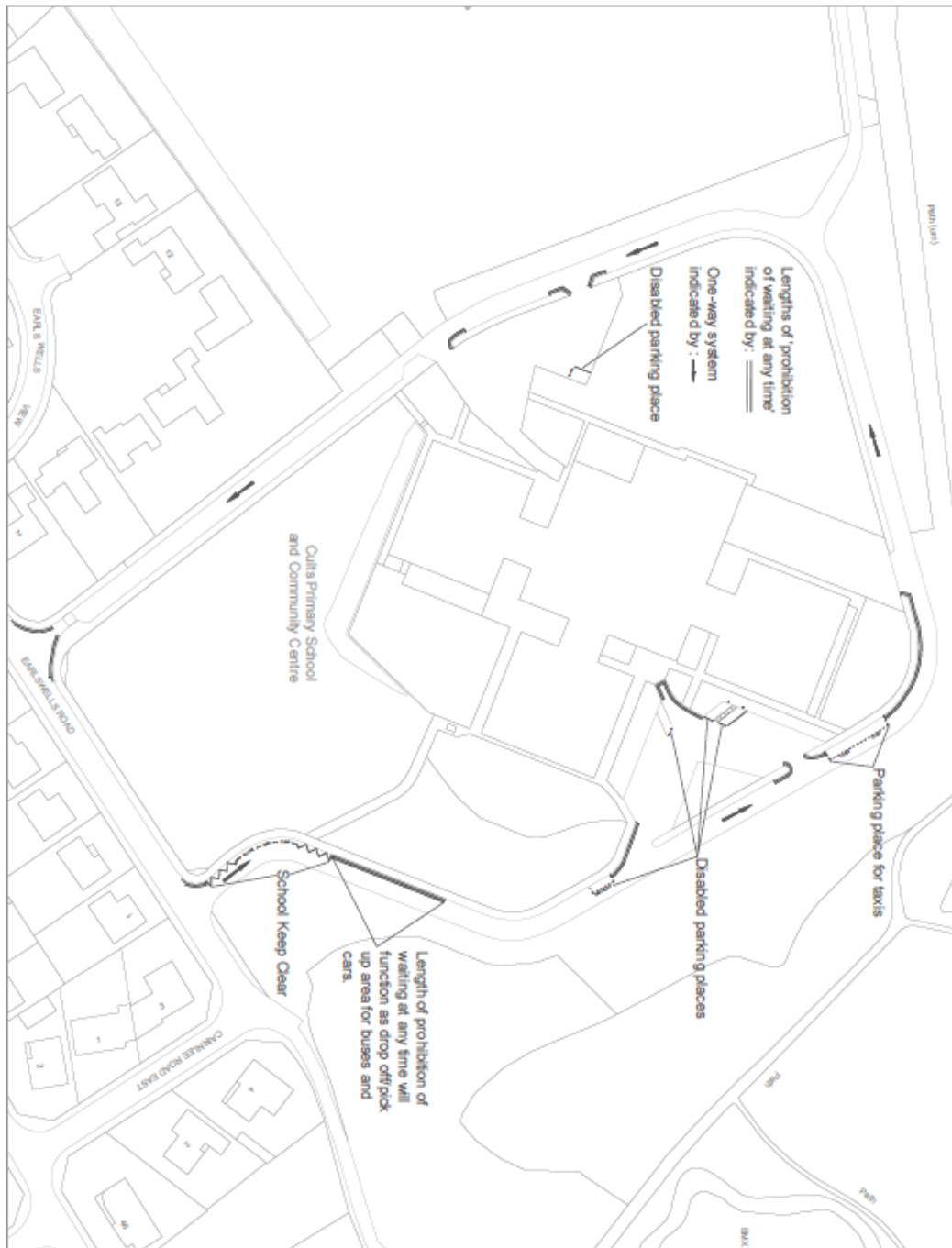



❖ The following proposals will be funded by the developer / business

Appendix 16

Tarbothill Road - Proposed revocation of 'School Keep Clear'

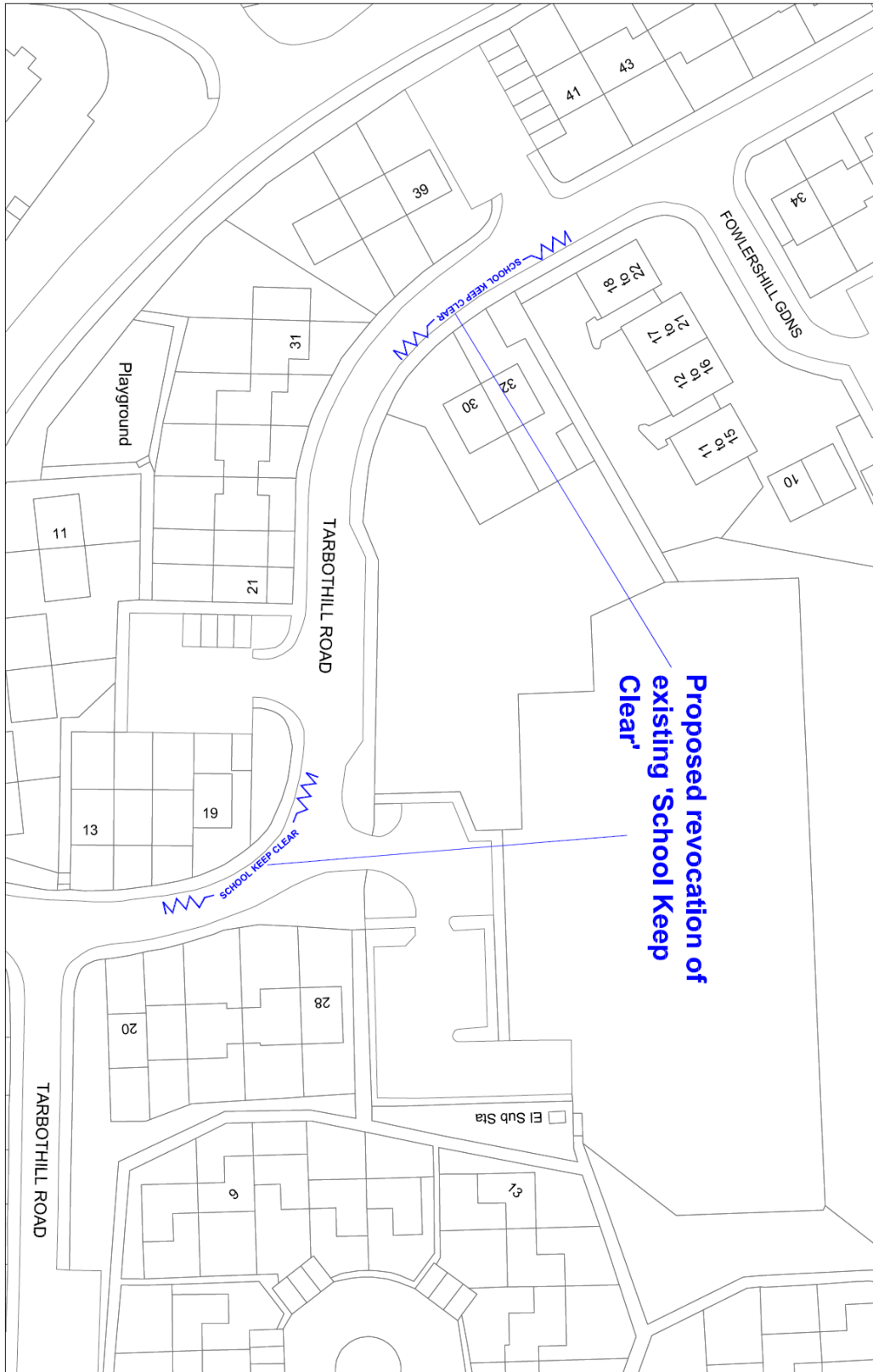

## Wellington Circle - 'At Any Time' waiting restrictions

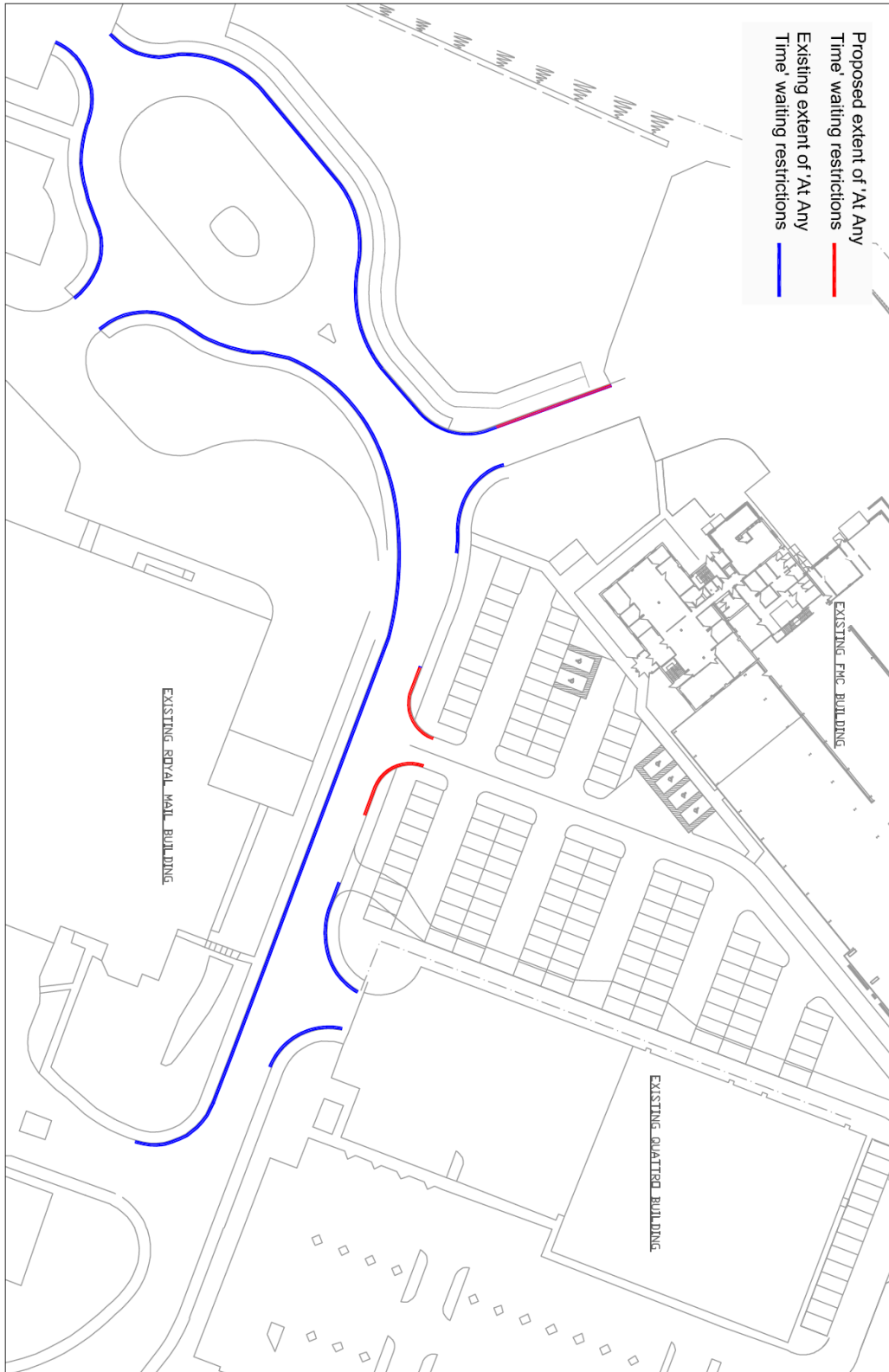

# Earns Heugh Road - 'At Any Time' waiting restrictions

